

8M20

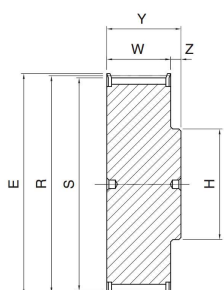

1

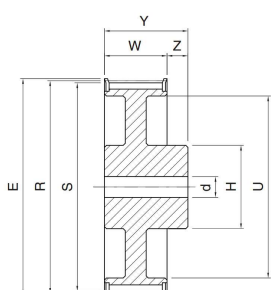

5

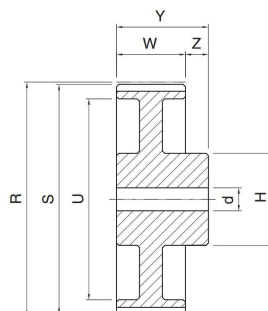

5A

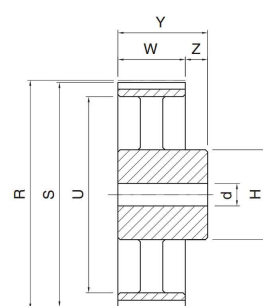

5B

Artikel	Typ	Zähne	R Ø	S Ø	U Ø	e Ø	W	H Ø	Y	Z	d Ø	Material
18 - 8 M 20	1	18	45.84	44.46	-	51	28	32	38	10	-	Stahl
20 - 8 M 20	1	20	50.93	49.56	-	57	28	36	38	10	-	Stahl
22 - 8 M 20	1	22	56.02	54.65	-	60	28	43	38	10	-	Stahl
24 - 8 M 20	1	24	61.12	59.74	-	66	28	45	38	10	-	Stahl
26 - 8 M 20	1	26	66.21	64.84	-	70	28	48	38	10	-	Stahl
28 - 8 M 20	1	28	71.30	70.08	-	75	28	55	38	10	-	Stahl
30 - 8 M 20	1	30	76.39	75.13	-	83	28	60	38	10	-	Stahl
32 - 8 M 20	1	32	81.49	80.16	-	87	28	64	38	10	-	Stahl
34 - 8 M 20	1	34	86.58	85.21	-	91	28	70	38	10	-	Stahl
36 - 8 M 20	1	36	91.67	90.30	-	97	28	75	38	10	-	Stahl
38 - 8 M 20	1	38	96.77	95.39	-	102	28	80	38	10	-	Stahl
40 - 8 M 20	1	40	101.86	100.49	-	106	28	85	38	10	-	Stahl
44 - 8 M 20	1	44	112.05	110.67	-	120	28	96	38	10	-	Guss
48 - 8 M 20	1	48	122.23	120.86	-	128	28	104	38	10	-	Guss
56 - 8 M 20	5	56	142.60	141.23	117	150	28	80	38	10	12	Guss
60 - 8 M 20	5	60	152.79	151.42	127	158	28	80	38	10	12	Guss
64 - 8 M 20	5	64	162.97	161.60	137	168	28	80	38	10	12	Guss
72 - 8 M 20	5	72	183.35	181.97	158	192	28	80	38	10	12	Guss
80 - 8 M 20	5A	80	203.72	202.35	179	-	28	90	38	10	12	Guss
84 - 8 M 20	5A	84	213.90	212.53	190	-	28	90	38	10	12	Guss
90 - 8 M 20	5A	90	229.18	227.81	204	-	28	90	38	10	12	Guss
112 - 8 M 20	5B	112	285.21	283.83	260	-	28	90	38	10	18	Guss
144 - 8 M 20	5B	144	366.69	365.32	342	-	28	90	38	10	20	Guss
168 - 8 M 20	5B	168	427.80	426.44	403	-	28	100	38	10	20	Guss
192 - 8 M 20	5B	192	488.92	487.54	465	-	28	100	38	10	20	Guss