

Dimensions des poulies dentées, pas en pouces - moyeu plein



PD ... H 150

H

Code	Nb de dents	Type	E [mm]	R [mm]	S [mm]	U [mm]	H [mm]	d [mm]	W [mm]	Y [mm]	Z [mm]	Flasque	Matière
PD14H150	14	1	64,0	56,60	55,23	-	40,0	-	46,0	58,0	12,0	avec flasque	acier
PD15H150	15	1	66,5	60,64	59,27	-	45,0	-	46,0	58,0	12,0		
PD16H150	16	1	70,0	64,68	63,31	-	47,0	-	46,0	58,0	12,0		
PD17H150	17	1	75,0	68,72	67,35	-	49,0	-	46,0	58,0	12,0		
PD18H150	18	1	79,0	72,77	71,40	-	57,0	-	46,0	58,0	12,0		
PD19H150	19	1	82,5	76,81	75,44	-	60,0	-	46,0	58,0	12,0		
PD20H150	20	1	87,0	80,85	79,48	-	64,0	-	46,0	58,0	12,0		
PD21H150	21	1	91,0	84,89	83,52	-	64,0	-	46,0	58,0	12,0		
PD22H150	22	1	94,0	88,94	87,57	-	70,0	-	46,0	58,0	12,0		
PD23H150	23	1	97,0	92,98	91,61	-	72,0	-	46,0	58,0	12,0		
PD24H150	24	1	102,0	97,02	95,65	-	80,0	-	46,0	58,0	12,0		
PD25H150	25	1	106,0	101,06	99,69	-	80,0	-	46,0	58,0	12,0		
PD26H150	26	1	112,0	105,11	103,74	-	85,0	-	46,0	58,0	12,0		
PD27H150	27	1	115,0	109,15	107,78	-	88,0	-	46,0	58,0	12,0		
PD28H150	28	1	120,0	113,19	111,92	-	94,0	-	46,0	58,0	12,0		
PD29H150	29	1	120,0	117,23	115,86	-	96,0	-	46,0	58,0	12,0		
PD30H150	30	1	128,0	121,28	119,91	-	104,0	-	46,0	58,0	12,0		
PD32H150	32	1	135,0	129,36	127,99	-	112,0	-	46,0	58,0	12,0		
PD33H150	33	1	142,0	133,40	132,03	-	112,0	-	46,0	58,0	12,0		
PD34H150	34	1	142,0	137,45	136,08	-	118,0	-	46,0	58,0	12,0		
PD35H150	35	3	150,0	141,49	140,12	118,0	75,0	12,0	46,0	58,0	12,0		
PD36H150	36	3	150,0	145,53	144,16	118,0	75,0	12,0	46,0	58,0	12,0		
PD38H150	38	3	158,0	153,62	152,25	126,0	75,0	12,0	46,0	58,0	12,0		
PD40H150	40	3	168,0	161,70	160,33	134,0	75,0	12,0	46,0	70,0	24,0		
PD44H150	44	3	184,0	177,87	176,50	150,0	75,0	18,0	46,0	70,0	24,0		
PD45H150	45	3	192,0	181,91	180,54	154,0	75,0	18,0	46,0	70,0	24,0		
PD48H150	48	3	200,0	194,04	192,67	166,0	75,0	18,0	46,0	70,0	24,0		
PD49H150	49	3A	-	198,08	196,71	170,0	75,0	18,0	46,0	70,0	24,0		
PD50H150	50	3A	-	202,13	200,76	174,0	75,0	18,0	46,0	70,0	24,0		
PD52H150	52	3A	-	210,21	208,84	182,0	75,0	18,0	46,0	70,0	24,0		
PD60H150	60	3A	-	242,55	241,18	215,0	80,0	18,0	46,0	70,0	24,0		
PD70H150	70	3A	-	282,98	281,61	255,0	80,0	24,0	46,0	70,0	24,0		
PD72H150	72	3A	-	291,06	289,69	263,0	80,0	24,0	46,0	70,0	24,0		
PD82H150	82	5A	-	331,49	330,12	304,0	80,0	24,0	46,0	70,0	24,0		
PD84H150	84	5A	-	339,57	338,20	312,0	90,0	24,0	46,0	70,0	24,0		
PD94H150	94	5A	-	380,00	378,63	352,0	90,0	24,0	46,0	70,0	24,0		
PD96H150	96	5A	-	388,08	386,71	360,0	100,0	24,0	46,0	70,0	24,0		
PD106H150	106	5A	-	428,51	427,14	401,0	100,0	24,0	46,0	70,0	24,0		
PD116H150	116	5A	-	468,93	467,56	441,0	100,0	24,0	46,0	70,0	24,0		
PD118H150	118	5A	-	477,02	475,65	449,0	100,0	24,0	46,0	70,0	24,0		
PD120H150	120	5A	-	485,10	483,73	458,0	100,0	24,0	46,0	70,0	24,0		
PD150H150	150	5A	-	606,38	605,01	579,0	100,0	24,0	46,0	70,0	24,0		
PD152H150	152	5A	-	614,46	613,09	587,0	100,0	24,0	46,0	70,0	24,0		
PD154H150	154	5A	-	622,55	621,17	595,0	100,0	24,0	46,0	70,0	24,0		
PD156H150	156	5A	-	630,63	629,26	603,0	120,0	24,0	46,0	70,0	24,0		

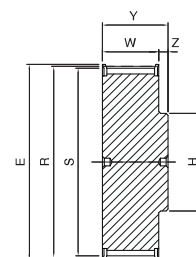

1

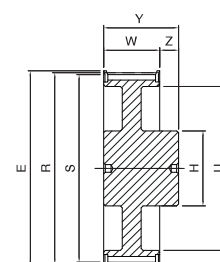

3*

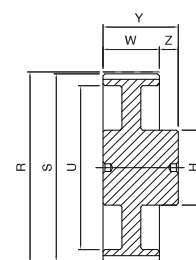

3A*

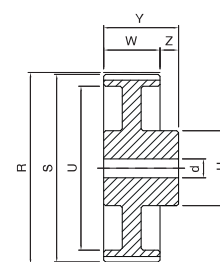

5A

* = Un pré-alésage, de diamètre maximal «d», peut être présent.