

Dimensions des poulies dentées, pas en pouces - moyeu plein



PD ... H 200

H

Code	Nb de dents	Type	E [mm]	R [mm]	S [mm]	U [mm]	H [mm]	d [mm]	W [mm]	Y [mm]	Z [mm]	Flasque	Matière
PD14H200	14	1	64,0	56,60	55,23	-	40,0	-	59,5	72,0	12,5	avec flasque	acier
PD15H200	15	1	66,5	60,64	59,27	-	45,0	-	59,5	72,0	12,5		
PD16H200	16	1	70,0	64,68	63,31	-	47,0	-	59,5	72,0	12,5		
PD17H200	17	1	75,0	68,72	67,35	-	49,0	-	59,5	72,0	12,5		
PD18H200	18	1	79,0	72,77	71,40	-	57,0	-	59,5	72,0	12,5		
PD19H200	19	1	82,5	76,81	75,44	-	60,0	-	59,5	72,0	12,5		
PD20H200	20	1	87,0	80,85	79,48	-	64,0	-	59,5	72,0	12,5		
PD21H200	21	1	91,0	84,89	83,52	-	64,0	-	59,5	72,0	12,5		
PD22H200	22	1	94,0	88,94	87,57	-	70,0	-	59,5	72,0	12,5		
PD23H200	23	1	97,0	92,98	91,61	-	72,0	-	59,5	72,0	12,5		
PD24H200	24	1	102,0	97,02	95,65	-	80,0	-	59,5	72,0	12,5		
PD25H200	25	1	106,0	101,06	99,69	-	80,0	-	59,5	72,0	12,5		
PD26H200	26	1	112,0	105,11	103,74	-	85,0	-	59,5	72,0	12,5		
PD27H200	27	1	115,0	109,15	107,78	-	88,0	-	59,5	72,0	12,5		
PD28H200	28	1	120,0	113,19	111,92	-	94,0	-	59,5	72,0	12,5		
PD29H200	29	1	120,0	117,23	115,86	-	96,0	-	59,5	72,0	12,5		
PD30H200	30	1	128,0	121,28	119,91	-	104,0	-	59,5	72,0	12,5		
PD32H200	32	1	135,0	129,36	127,99	-	112,0	-	59,5	72,0	12,5		
PD33H200	33	1	142,0	133,40	132,03	-	112,0	-	59,5	72,0	12,5		
PD34H200	34	1	142,0	137,45	136,08	-	118,0	-	59,5	72,0	12,5		
PD35H200	35	3	150,0	141,49	140,12	118,0	80,0	12,0	59,5	72,0	12,5		
PD36H200	36	3	150,0	145,53	144,16	118,0	80,0	12,0	59,5	72,0	12,5		
PD38H200	38	3	158,0	153,62	152,25	126,0	80,0	12,0	59,5	72,0	12,5		
PD40H200	40	3	168,0	161,70	160,33	134,0	80,0	12,0	59,5	72,0	12,5		
PD44H200	44	3	184,0	177,87	176,50	150,0	80,0	18,0	59,5	72,0	12,5		
PD45H200	45	3	192,0	181,91	180,54	154,0	80,0	18,0	59,5	72,0	12,5		
PD48H200	48	3	200,0	194,04	192,67	166,0	80,0	24,0	59,5	80,0	20,5		
PD49H200	49	3A	-	198,08	196,71	170,0	80,0	24,0	59,5	80,0	20,5		
PD50H200	50	3A	-	202,13	200,76	174,0	80,0	24,0	59,5	80,0	20,5		
PD52H200	52	3A	-	210,21	208,84	182,0	80,0	24,0	59,5	80,0	20,5		
PD60H200	60	3A	-	242,55	241,18	215,0	90,0	24,0	59,5	80,0	20,5		
PD70H200	70	3A	-	282,98	281,61	255,0	90,0	28,0	59,5	80,0	20,5		
PD72H200	72	3A	-	291,06	289,69	263,0	90,0	28,0	59,5	80,0	20,5		
PD82H200	82	5A	-	331,49	330,12	304,0	90,0	28,0	59,5	80,0	20,5		
PD84H200	84	5A	-	339,57	338,20	312,0	100,0	28,0	59,5	80,0	20,5		
PD94H200	94	5A	-	380,00	378,63	352,0	100,0	28,0	59,5	80,0	20,5		
PD96H200	96	5A	-	388,08	386,71	360,0	100,0	28,0	59,5	80,0	20,5		
PD106H200	106	5A	-	428,51	427,14	401,0	100,0	28,0	59,5	80,0	20,5		
PD116H200	116	5A	-	468,93	467,56	441,0	100,0	28,0	59,5	80,0	20,5		
PD118H200	118	5A	-	477,02	475,65	449,0	100,0	28,0	59,5	80,0	20,5		
PD120H200	120	5A	-	485,10	483,73	458,0	120,0	28,0	59,5	80,0	20,5		
PD150H200	150	5A	-	606,38	605,01	579,0	120,0	28,0	59,5	80,0	20,5		
PD152H200	152	5A	-	614,46	613,09	587,0	120,0	28,0	59,5	80,0	20,5		
PD154H200	154	5A	-	622,55	621,17	595,0	120,0	28,0	59,5	80,0	20,5		
PD156H200	156	5A	-	630,63	629,26	603,0	130,0	28,0	59,5	80,0	20,5		

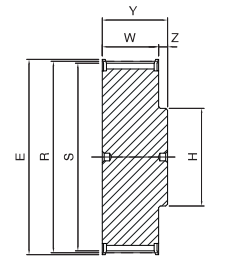

1

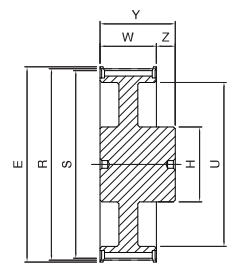

3*

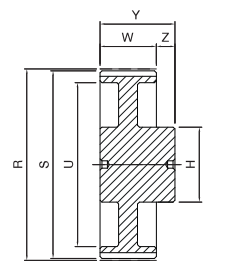

3A*

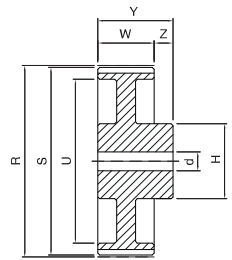

5A

* = Un pré-alésage, de diamètre maximal "d", peut être présent.