

Dimensions des poulies dentées, pas en pouces - moyeu plein



PD ... XH400

XH

Code	Nb de dents	Type	E [mm]	R [mm]	S [mm]	U [mm]	H [mm]	d [mm]	W [mm]	Y [mm]	Z [mm]	Flasque	Matière
PD18XH400	18	1	134,0	127,34	124,55	-	100,0	-	119,0	135,0	16,0	avec flasque	fonte
PD19XH400	19	1	142,0	134,41	131,62	-	107,0	-	119,0	135,0	16,0		
PD20XH400	20	1	150,0	141,49	138,70	-	114,0	-	119,0	135,0	16,0		
PD21XH400	21	1	158,0	148,56	145,77	-	122,0	-	119,0	135,0	16,0		
PD22XH400	22	1	166,0	155,64	152,85	-	128,0	-	119,0	135,0	16,0		
PD24XH400	24	1	177,0	169,79	167,00	-	141,0	-	119,0	135,0	16,0		
PD25XH400	25	1	186,0	176,86	174,07	-	148,0	-	119,0	135,0	16,0		
PD26XH400	26	1	191,0	183,94	181,15	-	157,0	-	119,0	135,0	16,0		
PD27XH400	27	1	200,0	191,01	188,22	-	158,0	-	119,0	135,0	16,0		
PD28XH400	28	1	209,0	198,08	195,29	-	169,0	-	119,0	135,0	16,0		
PD30XH400	30	3	216,0	212,23	209,44	170,0	120,0	-	119,0	135,0	16,0		
PD32XH400	32	3	232,0	226,38	223,59	184,0	120,0	-	119,0	135,0	16,0		
PD34XH400	34	3	261,0	240,53	237,74	198,0	120,0	-	119,0	135,0	16,0		
PD38XH400	38	3	274,0	268,83	266,03	227,0	120,0	-	119,0	135,0	16,0		
PD40XH400	40	3	288,0	282,98	280,19	241,0	120,0	-	119,0	135,0	16,0		
PD46XH400	46	3A	-	325,42	322,63	283,0	140,0	-	119,0	135,0	16,0		
PD48XH400	48	5A	-	339,57	336,78	297,0	140,0	19,0	119,0	135,0	16,0		
PD58XH400	58	5A	-	410,32	407,52	368,0	140,0	19,0	119,0	135,0	16,0		
PD60XH400	60	5A	-	424,47	421,68	382,0	140,0	19,0	119,0	135,0	16,0		
PD70XH400	70	5B	-	495,21	492,42	453,0	140,0	19,0	119,0	135,0	16,0		
PD72XH400	72	5B	-	509,36	506,57	467,0	140,0	19,0	119,0	135,0	16,0		
PD78XH400	78	5B	-	551,80	549,01	510,0	140,0	19,0	119,0	135,0	16,0		
PD80XH400	80	5B	-	565,95	563,16	524,0	140,0	19,0	119,0	135,0	16,0		
PD82XH400	82	5B	-	580,10	577,31	538,0	140,0	19,0	119,0	135,0	16,0		
PD84XH400	84	5B	-	594,25	591,46	552,0	160,0	19,0	119,0	135,0	16,0		
PD94XH400	94	5B	-	664,99	662,20	623,0	150,0	19,0	119,0	135,0	16,0		
PD96XH400	96	5B	-	679,14	676,35	637,0	160,0	19,0	119,0	135,0	16,0		
PD118XH400	118	5B	-	834,78	831,99	792,0	160,0	19,0	119,0	135,0	16,0		
PD120XH400	120	5B	-	848,93	846,14	806,0	170,0	19,0	119,0	135,0	16,0		

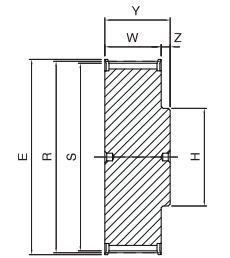

1

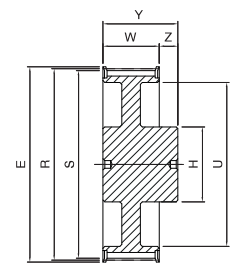

3

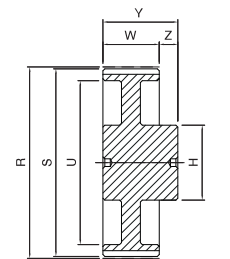

3A

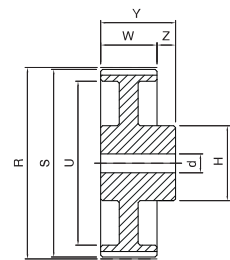

5A

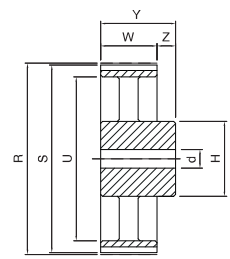

5B