

8M20

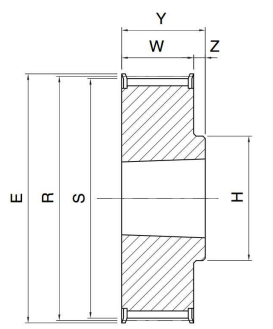

2

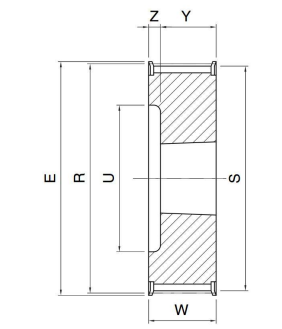

4

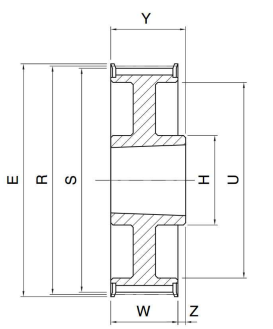

9

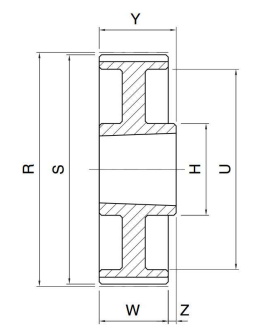

9A



9B

Article	Dents	Type	R	S	e Ø	U	W	H	Z	Y	SER-SIT®	Matériel
B 22 S 8 M 20	22	4	56.02	54.65	62	38	28	-	6	22	1008	Fonte
B 24 S 8 M 20	24	4	61.12	59.74	67	42	28	-	6	22	1108	Fonte
B 26 S 8 M 20	26	4	66.21	64.84	73	45	28	-	6	22	1108	Fonte
B 28 S 8 M 20	28	4	71.30	69.93	77	52	28	-	6	22	1108	Fonte
B 30 S 8 M 20	30	4	76.39	75.02	84	56	28	-	6	22	1108	Fonte
B 32 S 8 M 20	32	4	81.49	80.12	88	65	28	-	3	25	1610	Fonte
B 34 S 8 M 20	34	4	86.58	85.21	94	66	28	-	3	25	1610	Fonte
B 36 S 8 M 20	36	4	91.67	90.30	98	68	28	-	3	25	1610	Fonte
B 38 S 8 M 20	38	4	96.77	95.39	104	76	28	-	3	25	1610	Fonte
B 40 S 8 M 20	40	4	101.86	100.49	108	80	28	-	3	25	1610	Fonte
B 44 S 8 M 20	44	2	112.05	110.67	121	-	28	99	4	32	2012	Fonte
B 48 S 8 M 20	48	2	122.23	120.86	129	-	28	105	4	32	2012	Fonte
B 56 S 8 M 20	56	2	142.60	141.23	149	-	28	105	4	32	2012	Fonte
B 64 S 8 M 20	64	9	162.97	161.60	168	140	28	110	4	32	2012	Fonte
B 72 S 8 M 20	72	9	183.35	181.97	191	158	28	110	4	32	2012	Fonte
B 80 S 8 M 20	80	9A	203.72	202.35	0	178	28	110	4	32	2012	Fonte
B 90 S 8 M 20	90	9B	229.18	227.81	0	204	28	110	4	32	2012	Fonte